

DATA SHEET

FOR RIVETS ALUMINIUM/STEEL WITH DOMEHEAD

Rivet: Aluminium AlMg 3.5
Mandrel: steel zincplated
UNE-EN ISO 15977

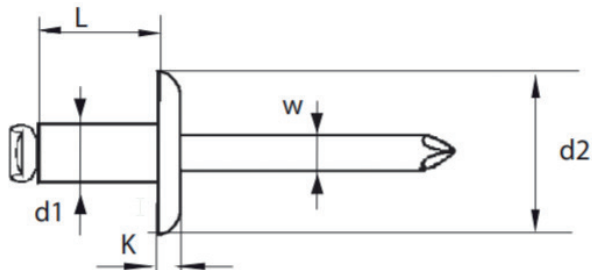

d1 = diameter of rivet
L = length of rivet
d2 = diameter of head
K = height of head
w = diameter of mandrel
E = grip length



| d1 | L | d2 | K | w | E | Item nr. |
|-----|----|-----|-----|------|-----------|----------|
| 4.0 | 6 | 8.0 | 1.4 | 2.2 | 1.0-3.0 | 55924006 |
| | 8 | | | | 3.0-5.0 | 55924008 |
| | 12 | | | | 6.5-8.5 | 55924012 |
| | 14 | | | | 8.5-10.5 | 55924014 |
| | 16 | | | | 10.5-12.5 | 55924016 |
| | 18 | | | | 12.5-14.5 | 55924018 |
| | 25 | | | | 16.5-21.5 | 55924025 |
| 4.8 | 6 | 9.5 | 1.5 | 2.65 | 0.5-3.0 | 55924806 |
| | 8 | | | | 3.0-4.5 | 55924808 |
| | 12 | | | | 6.0-8.0 | 55924812 |
| | 16 | | | | 10.0-12.0 | 55924816 |
| | 18 | | | | 12.0-14.0 | 55924818 |
| | 21 | | | | 14.0-17.0 | 55924821 |
| | 24 | | | | 17.0-20.0 | 55924824 |
| 5.0 | 8 | 9.5 | 1.6 | 2.5 | 3.0-4.5 | 55925008 |
| | 16 | | | | 10.0-12.0 | 55925016 |
| | 18 | | | | 12.0-14.0 | 55925018 |
| | 25 | | | | 16.0-21.0 | 55925025 |

specifications in mm

Load capacity of the assembly for sheering strain/ tensile strain:

4.0: 1.250N / 1.800N
4.8: 1.850N / 2.600N
5.0: 2.150N / 3.100N

DATENBLATT

FÜR FLACHRUNDKOPF BLINDNIETEN AUS ALUMINIUM/STAHL

Niethülse: Aluminium Al Mg 3,5
Dorn: Stahl, verzinkt A1K
UNE-EN ISO 15977

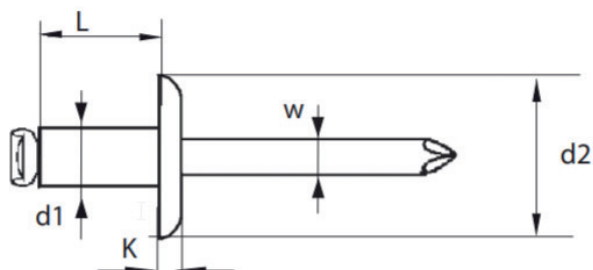

d1 = Durchmesser der Niete
L = Länge der Niete
d2 = Durchmesser des Nietkopfs
K = Höhe des Nietkopfs
W = Durchmesser des Dorns
E = möglicher Klemmbereich

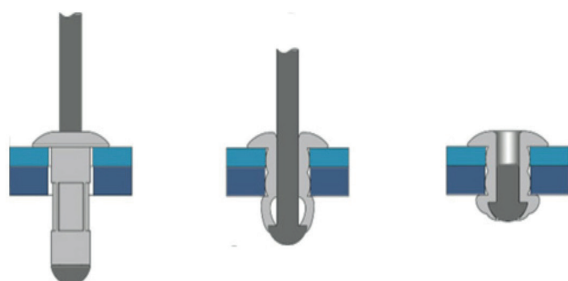

| d1 | L | d2 | K | w | E | Art.-Nr. |
|-----|----|-----|-----|------|-----------|----------|
| 4,0 | 6 | 8,0 | 1,4 | 2,2 | 1,0-3,0 | 55924006 |
| | 8 | | | | 3,0-5,0 | 55924008 |
| | 12 | | | | 6,5-8,5 | 55924012 |
| | 14 | | | | 8,5-10,5 | 55924014 |
| | 16 | | | | 10,5-12,5 | 55924016 |
| | 18 | | | | 12,5-14,5 | 55924018 |
| | 25 | | | | 16,5-21,5 | 55924025 |
| 4,8 | 6 | 9,5 | 1,5 | 2,65 | 0,5-3,0 | 55924806 |
| | 8 | | | | 3,0-4,5 | 55924808 |
| | 12 | | | | 6,0-8,0 | 55924812 |
| | 16 | | | | 10,0-12,0 | 55924816 |
| | 18 | | | | 12,0-14,0 | 55924818 |
| | 21 | | | | 14,0-17,0 | 55924821 |
| | 24 | | | | 17,0-20,0 | 55924824 |
| 5,0 | 8 | 9,5 | 1,6 | 2,5 | 3,0-4,5 | 55925008 |
| | 16 | | | | 10,0-12,0 | 55925016 |
| | 18 | | | | 12,0-14,0 | 55925018 |
| | 25 | | | | 16,0-21,0 | 55925025 |

Angaben in mm

Belastbarkeit der Nietverbindung auf Scherung / Zug:

4,0: 1.250N / 1.800N
4,8: 1.850N / 2.600N
5,0: 2.150N / 3.100N